

Company Presentation

'Concept to Product'



Global Footprint

Where is Core-Tech based? Which are the main business countries?

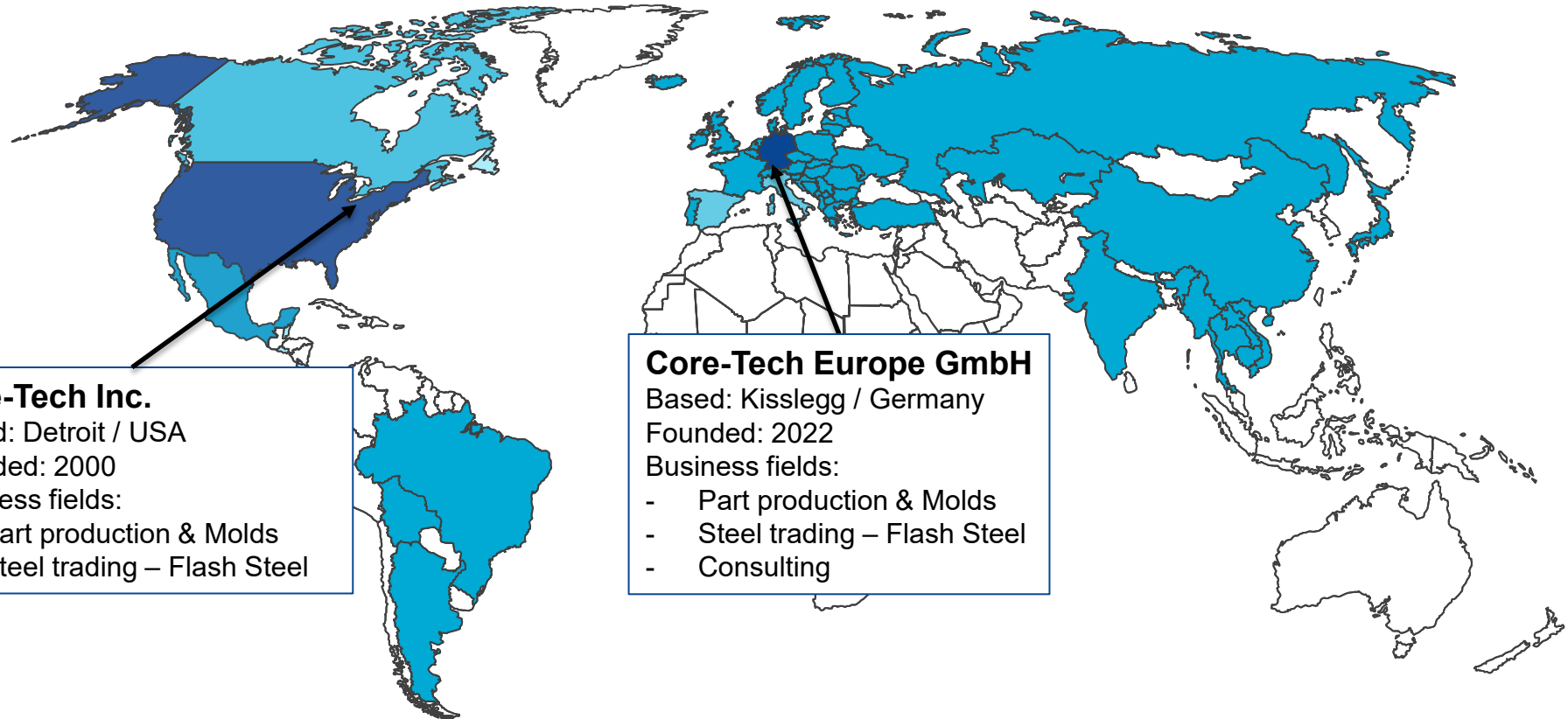

Note: Flash Steel is only in NATO- and NATO allies' countries available.

● Core-Tech Basements ● Countries of action

Services and Products

One Stop Supplier – in every project phase available to step in

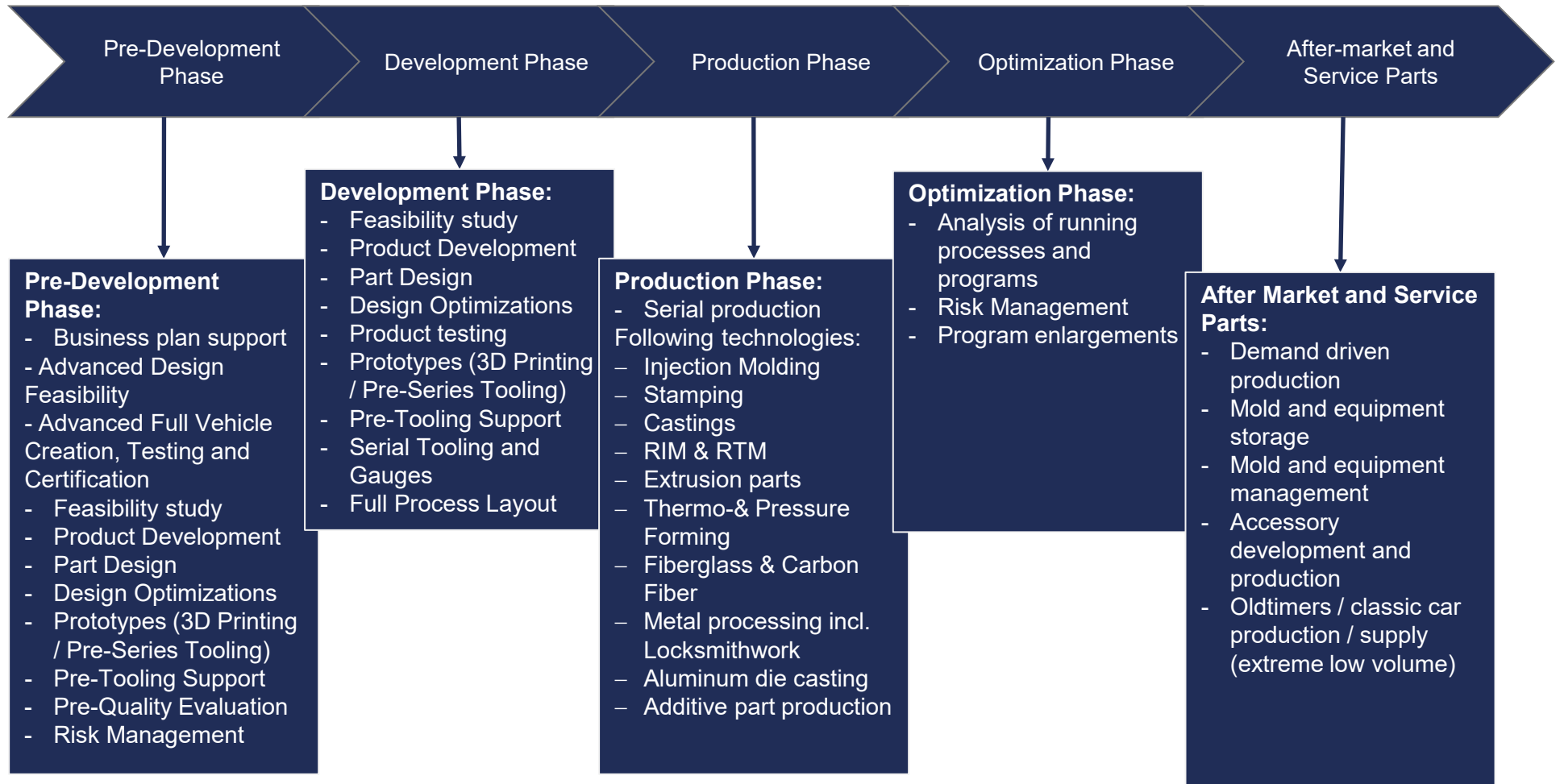

Executive Team behind the Core-Tech Group

Team and career Global and US team



David Phillips - Chief Executive Officer

Founded the company in March of 2000 to offer a single full-service supplier to my customer (Concept to Production).

- President of Silver Basis Eng. Americas
- Sales and Program Manager at Troy Tooling
- Tooling and Product Designer at Porsche Delta Tech
- Tool & Die Maker at Peters Tool and Die



Amy Chapman - Vice President of Core-Tech, Inc.

- Tier 1 Program Management to include: New Launches for BMW, VW, MBUSA, Volvo
- Tier 1 Procurement / Supply Chain Management
- Tier 1 Material / Production Planning
- Tier 1 Quality Management
- Tier 1 HR/Recruiting



James Osbourn - Sales and Program Manager

- General Manager
- Plant Manager
- Program Manager
- Plant Start-Up
- Purchasing
- Sales
- Tool Maker



Bob Fehan - Vice President of Engineering of Core-Tech, Inc.

- Director at Mahindra Automotive North America
- VP of Engineering at Gibbs Sports Amphibians
- General Manager – Magna International Specialty Vehicle Engineering working on the running boards and Front-End Modules.

Executive Team behind the Core-Tech Group

Team and career Global and European team



Hans-Jurgen Krug – General Manager Europe

- Founding member Core-Tech Europe
- Vice President Business Group Automotive Tooling at Silver Basis Group.
- Asian Senior Tooling Manager at Faurecia Automotive Exteriors
- Senior Commodity Manager Tooling and T&E Purchasing Manager China at Faurecia Automotive Interiors.

Tobias Glötzinger – General Manager Europe

- Founding member Core-Tech Europe
- Program Manager and Supply Management at Schnitzer Group
- Program Manager and Tool Shop Manager at Silver Basis Eng. Germany
- Leading several businesses and productions



Dirk Ihle – Director of Quality

- Dirk has over 15 years in Quality Management.
- Quality Management
 - Experience with: ISO 9001, EN 9100, TS 22163, DIN 6701, EN 15085
 - External Auditor ISO 9001, QMB & Quality Manager according to ISO 9001

References – Automotive

Production Injection Molding, Stamping, Extrusions and Stretch Bending

- **Component and tool production** by Core-Tech Group
- Front Grille Assy
- Cowl Panel
- Chrome Door Belt Moldings
- Door and Decklid Stamped Brackets
- Roof Ditch Moldings
- All After-Sales Production and Spare Parts



References – Yellow Goods / Automotive / Construction Plastic Extrusion

- 10+ extrusion machines
- Line range 15 – 140 [mm]
- PVC / TPO / TPE pure extrusion or with metal insert
- EPDM, PP, PE, PET, PA pure extrusion
- Projects in automotive, construction and yellow good industry ongoing

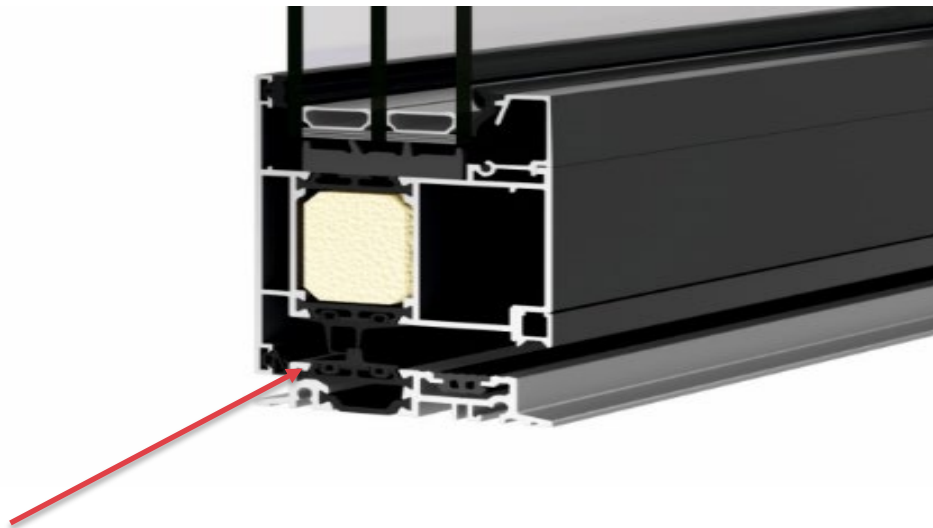

References – Automotive

Injection Molded Parts

- Injection molding with over 300 IMM ranging from 40t - 3750t
- Serial production and service parts
- Partly including assembly & painting services
- Logistics services by arrangement
- Mold storage available



Wheel Arch Moldings



Headlamp Bracket

References – Automotive

Injection Molded Parts

- Injection molding with over 300 IMM ranging from 40t - 3750t
- Serial production and service parts
- Partly including assembly & painting services
- Logistics services by arrangement
- Mold storage available



Grille Inserts

References – Automotive Injection Molded Parts

- Injection molding with over 300 IMM ranging from 40t - 3750t
- Serial production and service parts
- Partly including assembly & painting services
- Logistics services by arrangement
- Mold storage available

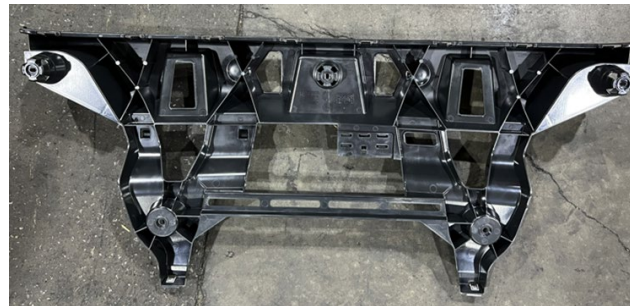

**Fascia Brackets / Front
End Module**



References – Automotive

Injection Molded Parts inclusive development and design

- Development and production **Floor mats & Trunk cover**
- Assembly **Locks and Logos**
- Production **injection molding tools, gauges and components**



References – Commercial Vehicles Casting Parts

- Several different parts for **After-Service Market** or **Spare Parts**
- Brake disks, brake drums, brake pads



- Aluminum Casted parts Brackets & Covers for Air Compressor Motors & Starter Motors

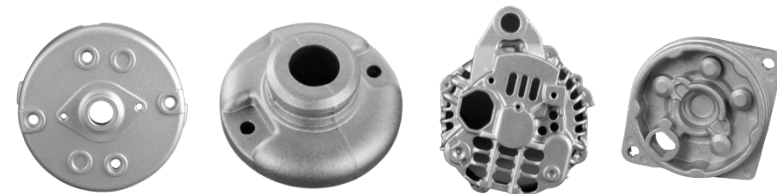

- Cast Iron, Ductile Iron, Aluminum Alloys & Parts from standard Steels Rods / Bars



This parts can order through Core-Tech Europe incl. all logistic & stock service or directly from our supplier Volmac in India

References – Current Parts in Production

Casting Parts

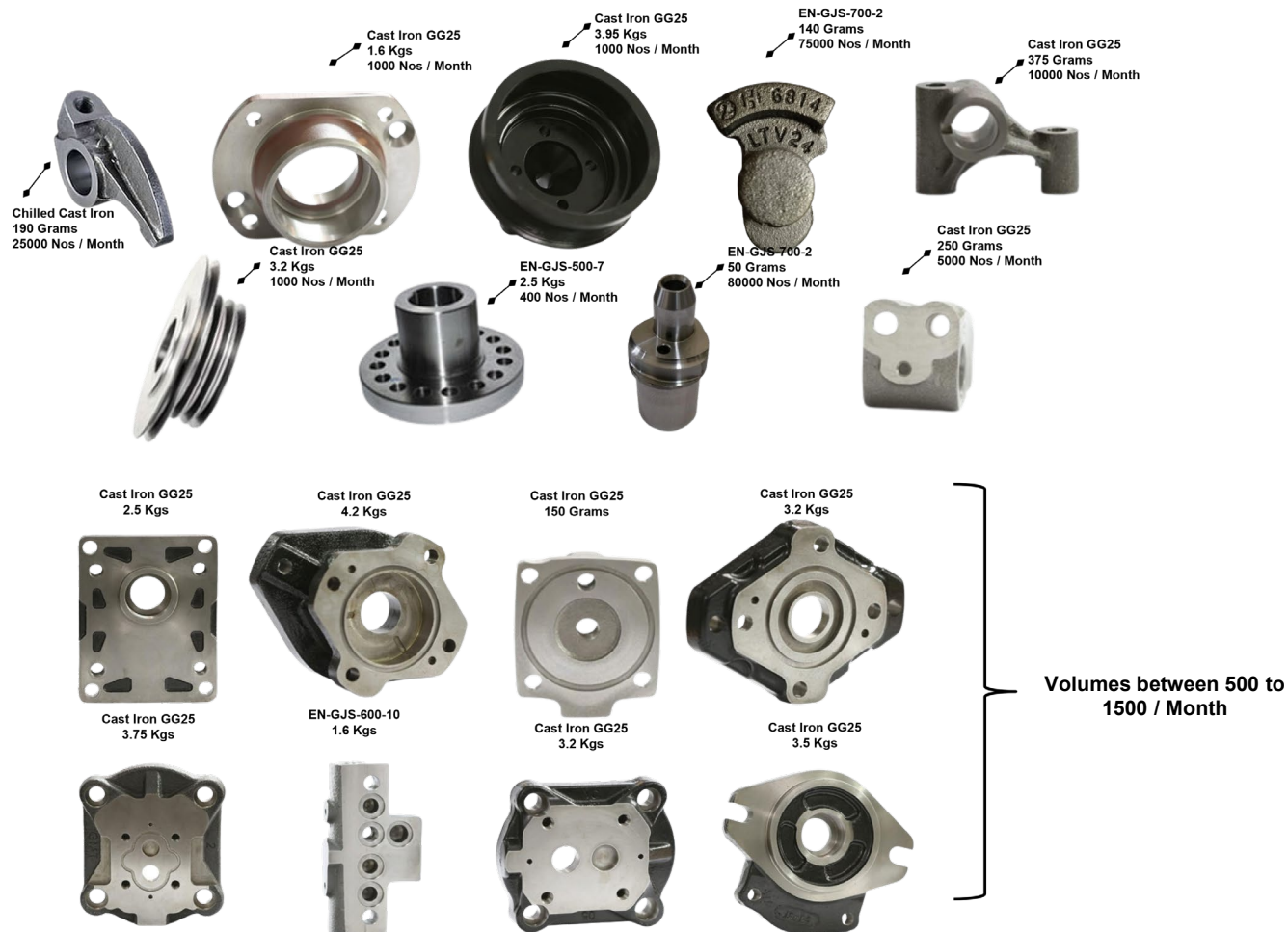

References – Glass Overmolding After-Serial Part Produktion

- **Hand-Over** of 21 molds from Tier-1 to Core-Tech
- Mold reparation and optimizations
- PPAP
- Process Optimization for smaller batches
- Incl. assembly process for 5 parts
- Logistic, packaging and storage on Core-Tech side
- Volume: ca. **15.000 parts**



References – Medical Technology

Injection Molded Parts inclusive development and design

- **Feasibility study and manufacturability consulting** by Core-Tech Group
- **Development and conception** of all plastic parts
- Production of all **injection molding tools & gauges**
- **Production** of injection-molded components – total 12 parts
- Volume: **20.000 parts**



References – Powersport

Design responsibility and production of several parts

- Evaluation of **optimal manufacturing processes**
- **Design optimization** from plastic to composite
- **Production** injection molding, thermoforming, resin transfer (RTM) and leather wrapped seating



References – Powersport

Design responsibility and production of several parts

- Complete design, engineering and manufacturing
- **Production** injection molding, thermoforming, resin transfer (RTM) and leather wrapped seating



References – Automotive Fiberglass (FRP)

- Evaluation of **optimal manufacturing processes**
- **Design optimization** from plastic to composite
- **Production** four different engine hoods with **Vacuum infusion process**



References – Low Volume Cars

Thermoforming

- Evaluation of manufacturing technologies
- Production several exterior components in the thermoforming process
- Volume: **6.000 parts**



References – Commercial Vehicles

Metal Fabrication

- Development by Core-Tech Group
- Production of **aluminum – welded structure**

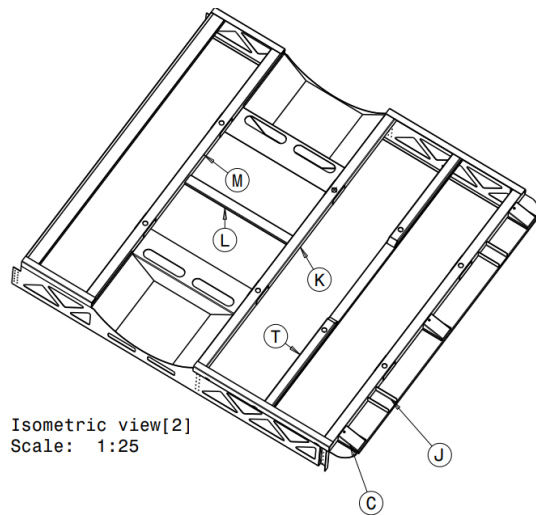

Isometric view[2]
Scale: 1:25

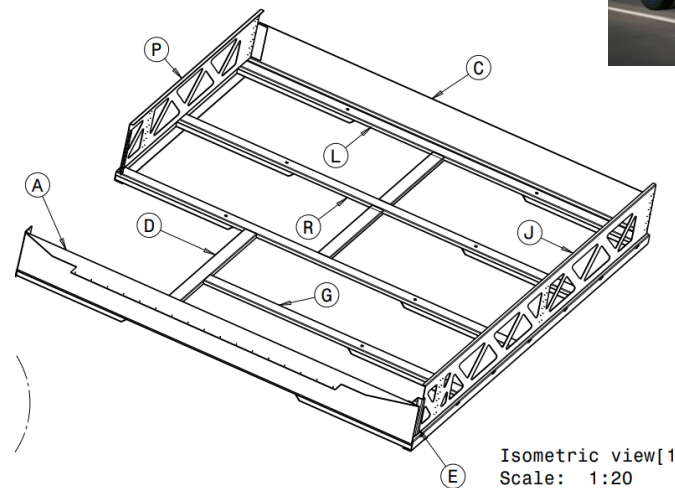

Isometric view[1]
Scale: 1:20

References – Agriculture Composites

15 Years Program

- Component development and production **RTM Tools & RTM Components**
- Volume: ca. **1000 parts**



IMM Equipment List

Press Information and Market					Location	
Press Tonnage	Total # of Presses	Low and High Volume Production	Service Parts	ASM	USA and Mexico	Europe
30	2	x	x	x		Romania, Germany
55	4	x	x	x	Oh, Mi	Romania
60	4	x		x	Puebla, Mexico	Italy, Romania
67	3	x	x	x	Mi	Italy, Romania
80	8	x		x	Puebla, Mexico	Italy, Romania, Germany
85	5	x	x	x	Mi, NC	
95	2	x	x	x	Oh, GA	Italy, Romania, Germany
100 (1k & 2k)	2	x		x	Puebla, Mexico	Italy, Romania
100	7	x	x	x	Ca, Mi	Italy, Romania
110	12	x	x	x	Mi, NC	Italy, Romania, Germany
120	6	x	x	x		Italy, Romania
132	2	x	x	x	Oh, Mi	
150	3	x		x	Puebla, Mexico	
150 (1k & 2k)	15	x	x	x	Mi, NC	Italy, Germany
170	8	x	x	x	Oh, MI, NC	
200	15	x	x	x	Oh, MI, NC	Romania, Germany
220	14	x	x	x	Oh, Mi	Italy
230	9	x	x	x	Mi, GA	Germany
250	10	x	x	x	Mi, CA, NC	Romania, Germany
300	15	x	x	x	Mi, NC	Italy, Romania
315	4	x	x	x	Mi	
335	4	x		x	Puebla Mexico	
335	5	x	x	x	Mi, Oh, CA	Germany

IMM Equipment List

Press Information and Market					Location	
Press Tonnage	Total # of Presses	Low and High Volume Production	Service Parts	ASM	USA and Mexico	Europe
400	34	x	x	x	Mi, GA,	Romania, Germany
420	1	x		x	Puebla Mexico	
440	5	x	x	x	Oh, CA, NC	
450	2	x	x	x	Mi	
484	2	x		x	CA	
500 (1k & 2k)	24	x	x	x	Oh, Mi, GA	Germany
530	1	x		x	Puebla Mexico	
530	3	x	x	x	Oh, Mi	Italy
550	6	x	x	x	Mi, Oh, CA	Germany
580	2	x	x	x	Mi, Oh	
600	2	x	x	x	Mi, GA,	
605	1	x	x	x	Oh	
610	2	x	x	x	Mi, NC	
650	2	x		x	Puebla Mexico	
650	5	x	x	x	Mi, CA	
660	1	x	x	x	Mi	
700	6	x	x	x	MI, CA	Germany
725	8	x	x	x	GA, NC	
730	5	x	x	x	Mi, CA	Germany
800	1	x	x	x	GA	
800	1	x		x	Puebla Mexico	
850	1	x		x	Puebla Mexico	
880	8	x	x	x	Mi, CA	

IMM Equipment List

Press Information and Market					Location	
Press Tonnage	Total # of Presses	Low and High Volume Production	Service Parts	ASM	USA and Mexico	Europe
899	2	x	x	x	Mi	
1000	1	x		x	Puebla Mexico	
1000	18	x	x	x	Oh, Mi, CA, GA, NC	
1100	6	x	x	x	Mi, CA, GA, NC	
1300	2	x		x	Puebla, Mexico	
1400	2	x		x	Puebla, Mexico	
1500	30	x	x	x	Mi, CA, GA, NC	Germany
1600	1	x		x	Puebla, Mexico	
1650	1	x	x	x	Mi	
1700	1	x	x	x	Mi	
1760	2	x	x	x	Mi	
2000	2	x		x	Puebla, Mexico, GA	
2000	5	x	x	x	Oh, Mi, CA, GA	
2200	6	x	x	x	Mi, GA	Germany
2500	5	x	x	x	Mi, GA	
3000	4	x	x	x	Mi, GA	
3200	1	x	x	x	GA	
3500	1	x	x	x	NV	
3750	3	x	x	x	NC, GA	
Total Presses:	375					

Production Locations

Our commitment to your product



- Available production locations in Europe and Northern America, Turkey and India
- Several production technologies available
- Always one-face to customer principal in all programs
- Long-term employers and long-term approach with staff and customers

● Production locations